



Electrical

Impedance	50 ohm				
Frequency Range	DC-4 GHz				
VSWR	1.25 max				
Input Avg Power	500W@ 25°C ambient, derating linearly to 30W at 100°C				
Peak Power	5kW (5 micro-sec pulse width, 6% duty cycle)				
Direction	Unidirectional, N male input, N female output (other configurations available)				
Attenuation(dB)	10	20	30	40	50
Accuracy(dB)	±2.0	±2.0	±2.0	±2.0	±2.0

Mechanical

Connector Body	Ternary alloy plated brass
Heat Sink	Black anodized aluminum
Center Contact	Gold plated beryllium copper/brass
Weight	7kg (Net), 7.5kg (Gross)

Environmental

Operating Temperature	-55°C to 100°C
Storage Temperature	-55°C to 125°C
RoHS	Compliant
Temperature Coefficient	<0.0004 dB/dB/°C

Dimensions(mm)

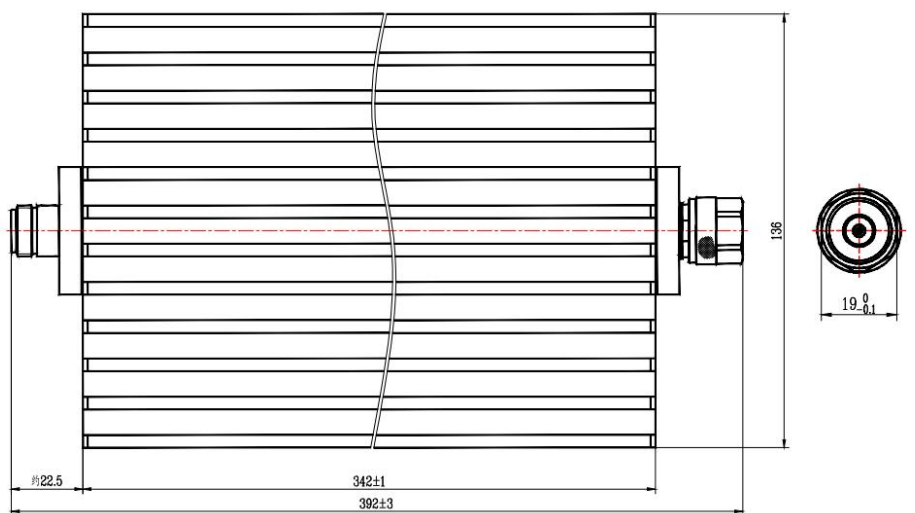
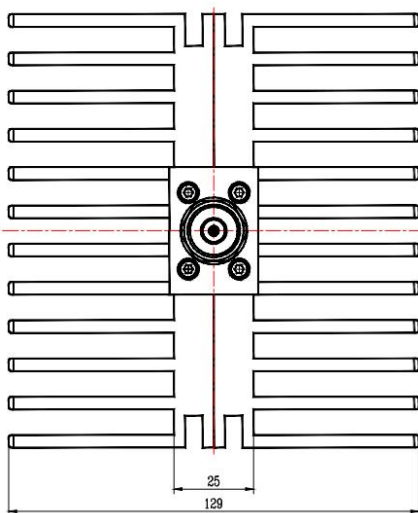

Notes

1. Always pay attention to the direction of attenuators.
2. To maintain best performance, recommended to use fan to keep the case temperature under 85°C.
3. Customized dB values, outlines and optimal accuracy/VSWR available.