

# Waveguide to Coaxial Adapter **AWR51SMAEL**

## WR51 to SMA Female, Cover Flange, End Launch



Rev 1

### Electrical

<b>Frequency Range</b>	14.5-22 GHz
<b>VSWR</b>	1.2 max

### Configuration

<b>Waveguide Size</b>	IEC	180
	EIA	WR51
<b>Flange Type</b>	IEC	UBR180
<b>Coax Connector</b>	SMA Female	
<b>Body Geometry</b>	End Launch	

### Materials

<b>Waveguide Body</b>	Aluminum, black or grey painted
<b>Connector Body</b>	Passivated stainless steel
<b>Center Contact</b>	Gold plated beryllium copper

### Mechanical & Environmental

<b>Operating Temp</b>	-40°C to 70°C
<b>Connector Interface</b>	MIL-STD-348
<b>RoHS</b>	Compliant

### Dimensions(mm)

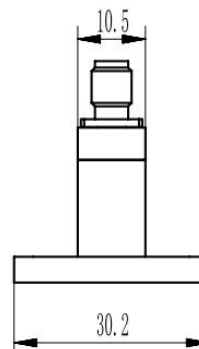
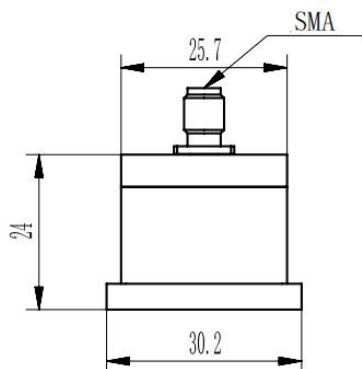
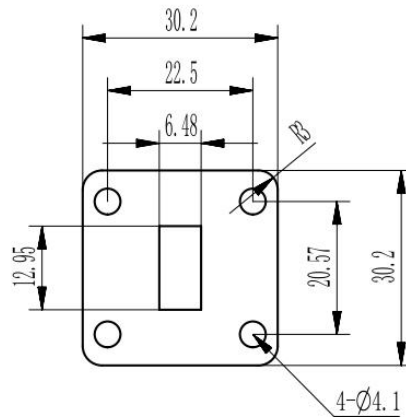

# Waveguide to Coaxial Adapter **AWR51SMAEL**

**WR51 to SMA Female, Cover Flange, End Launch**



Rev 1

## Typical Test Data

