

Coaxial Fixed Attenuator

RFHB06XXZC2



DC-6 GHz, 1-60 dB, 2 Watts, 2.2-5, Bidirectional

Rev 1

Electrical

Impedance	50 ohm				
Frequency Range	DC-6 GHz				
VSWR	1.25 max				
Input Avg Power	2W@ 25°C ambient, derating linearly to 0.2W at 100°C				
Peak Power	250W (5 micro-sec pulse width, 0.4% duty cycle)				
Direction	Bidirectional, 2.2-5 female to 2.2-5 male (other configurations available)				

Attenuation(dB)	1-6	7-10	11-20	21-30	40-60
Accuracy(dB)	±0.5	±0.5	±0.6	±0.8	±0.9

Mechanical

Connector Body	Ternary alloy plated brass
Heat Sink	N/A
Center Contact	Gold plated beryllium copper/brass
Net Weight	Approx 35 g

Environmental

Operating Temperature	-55°C to 100°C
Storage Temperature	-55°C to 125°C
RoHS	Compliant
Temperature Coefficient	<0.0004 dB/dB/°C

Dimensions(mm)

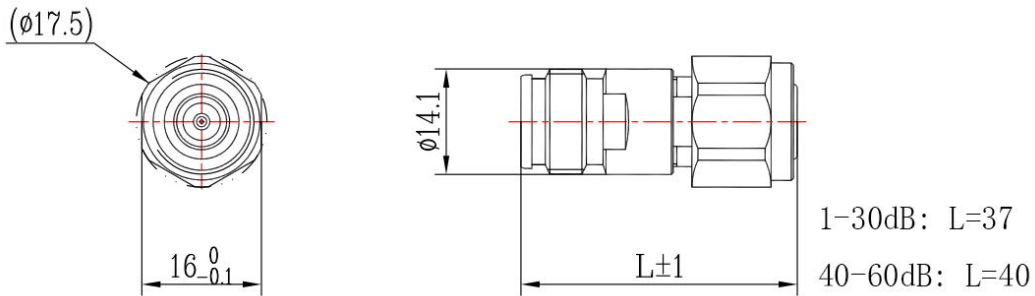

Notes

1. Customized dB values, outlines and optimal accuracy/VSWR available.

Model Description

RFHB06XXZC2

1. XX for dB value: 06=6dB, 30=30dB

2. Code for connector configuration:

A=female for two ends; B=male for two ends

C=female for one end and male for the other.