



**Electrical**

<b>Impedance</b>	50 ohm		
<b>Frequency Range</b>	DC-6 GHz		
<b>VSWR</b>	1.25 max		
<b>Input Avg Power</b>	2W@ 25°C ambient, derating linearly to 0.2W at 100°C		
<b>Peak Power</b>	250W (5 micro-sec pulse width, 0.4% duty cycle)		
<b>Direction</b>	Bidirectional, BNC female to BNC male (other configurations available)		

<b>Attenuation(dB)</b>	1-6	7-20	21-30	40-60
<b>Accuracy(dB)</b>	±0.3	±0.5	±0.75	±0.8

**Mechanical**

<b>Connector Body</b>	Ternary alloy plated brass
<b>Heat Sink</b>	N/A
<b>Center Contact</b>	Gold plated beryllium copper/brass
<b>Net Weight</b>	Approx 18 g

**Environmental**

<b>Operating Temperature</b>	-55°C to 100°C
<b>Storage Temperature</b>	-55°C to 125°C
<b>RoHS</b>	Compliant
<b>Temperature Coefficient</b>	<0.0004 dB/dB/°C

**Dimensions(mm)**

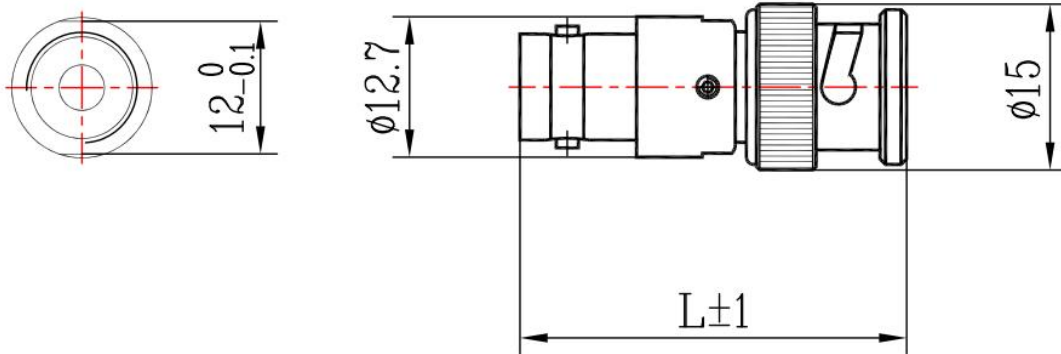

1-30dB: L=35  
40-60dB: L=38

**Notes**

- 1.To maintain best performance, recommended to use fan to keep the case temperature under 85°C.
- 2.Customized dB values, outlines and optimal accuracy/VSWR available.

**Model Description**

**RFHB06XXBC2**

- 1.XX for dB value: 06=6dB,30=30dB
- 2.Code for connector configuration:  
A=female for two ends; B=male for two ends  
C=female for one end and male for the other.