

# Waveguide Termination

## WT28A500

WR28, 26.3-40 GHz, 500 Watts, Square Cover Flange



Rev 1

### Electrical

Frequency Range	26.3-40 GHz
VSWR	1.15 max
Input Avg Power	500 Watts @ 25°C
Operating Temperature	-40°C ~ +70 °C

### Mechanical

Waveguide Size	WR28(R320)
Flange Type	IEC: UBR320
Waveguide Material	Aluminum
Waveguide Finish	Black painted
Heat Sink Material	Aluminum
Heat Sink Finish	Black painted
Weight	Approx 1.5kg

### Dimensions(mm)

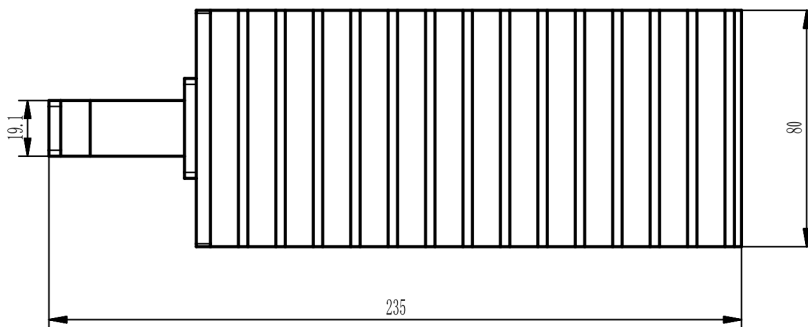
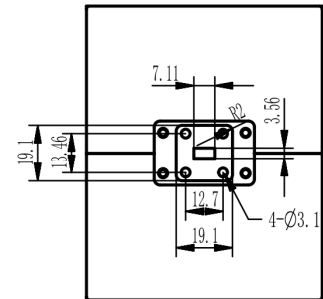
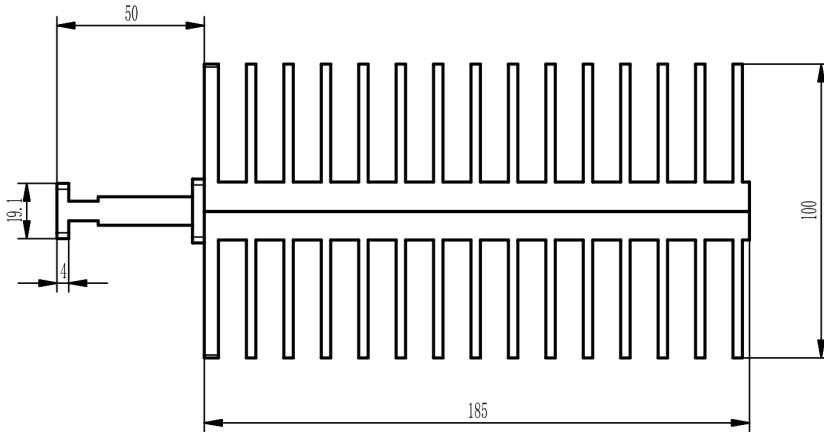



Typical Test Data

