

Waveguide Termination

WT90A

WR90, 8.20-12.5 GHz, 4 Watts, Square Cover Flange



Rev 1

Electrical

Frequency Range	8.20-12.5 GHz
VSWR	1.03 max
Input Avg Power	4 Watts @ 25°C
Operating Temperature	-40°C ~ +70°C

Mechanical

Waveguide Size	WR90(R100)
Flange Type	IEC: UBR100
Waveguide Material	Aluminum
Waveguide Finish	Grey painted
Net Weight	Approx 75g

Dimensions(mm)

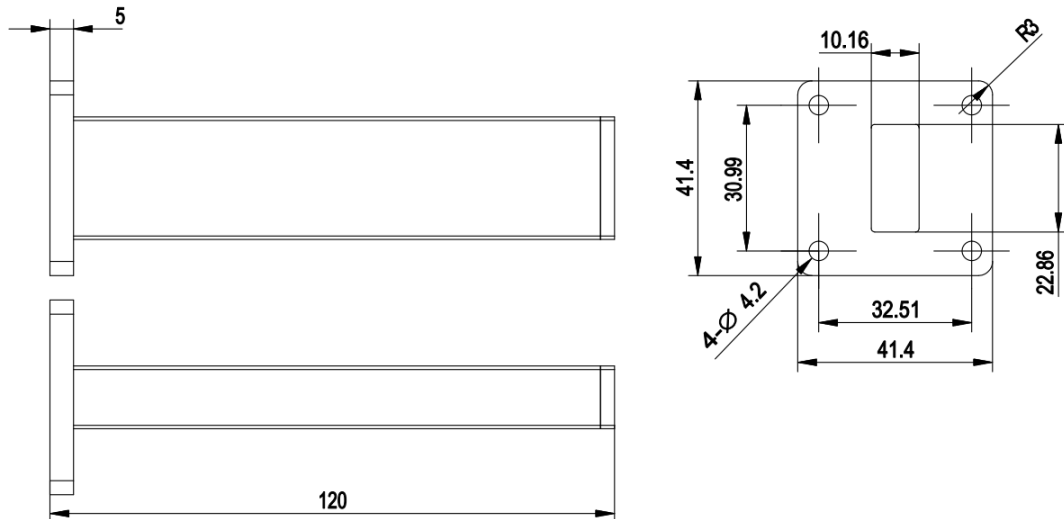



Typical Test Data

